

CGPE Heat Shrink Tubing

RAYCHEM | RAYCHEM CGPE
[View on TE.com >](#)



Heat Shrink Tubing

TE's CGPE Heat Shrink Tubing, economical and available in bright color and clear tubing that can be easily hot stamped. Automotive heat shrink tubing and consumer-goods applications tubing that operates in temperature range between -70°C to 105°C.



Primary Product Color: **Clear**

Wall Type: **Single Wall**

Expanded Inside Diameter (Min): **25.4 mm**

Recovered Inside Diameter (Max): **12.7 mm**

Shrink Ratio: **2:1**

Features

Reference Number

TE Internal Number	CAT-HST-CGPE
--------------------	--------------

Product Type Features

Tubing Product Type	Heat Shrink Tubing
Wall Type	Single Wall

Electrical Characteristics

Operating Voltage (Max) (kV)	.6
------------------------------	----

Body Features

Fluid Type	Brake Fluid, Water
Primary Product Color	Black, Blue, Clear, Red, White, Yellow
Shrink Ratio	2:1
Primary Product Material	Irradiated Modified Polyolefin
Flexibility	Flexible

Dimensions

Recovered Wall Thickness (Tolerance) (mm)	.07, .15, .25, 2.01
Recovered Wall Thickness (Tolerance) (in)	.003, .006, .01, .079
Product Length (mm)	10.3, 15
Product Length (in)	.406, .591



Recovered Wall Thickness (Nominal) (mm)	.4, .43, .5, .64, .76, .88
Recovered Wall Thickness (Nominal) (in)	.016, .017, .02, .025, .03, .035
Recovered Inside Diameter (Max) (mm)	.58, .8, 1.17, 1.57, 1.6, 2.36, 3.2, 4.8, 6.35, 7.49, 9.5, 12.7
Recovered Inside Diameter (Max) (in)	.023, .025, .031, .046, .062, .093, .125, .25, .295, .375, .5
Expanded Inside Diameter (Min) (mm)	1.17, 1.6, 2.36, 3.17, 3.2, 4.74, 4.75, 4.8, 6.35, 9.5, 11.96, 12.7, 19.05, 25.4
Expanded Inside Diameter (Min) (in)	.046, .063, .093, .125, .187, .189, .25, .375, .471, .5, .75, 1
Tubing Size Range (mm)	.8 - 1.6, 1.6 - 3.2, 2.4 - 4.8, 3.2 - 6.35, 4.8 - 9.5, 12.7 - 25.4
Tubing Size Range (in)	.031 - .063, .062 - .125, .093 - .187, .125 - .25, .187 - .375, .5 - 1

Usage Conditions

Shrink Temperature (Min) (°C)	85
Tubing Flammability Type	Non-Flame-Retardant
Operating Temperature Range (°C)	-70 - 105
Recovery Temperature (°C)	100, 110

Operation/Application

Mechanical Resistance	Fluids, Mechanical Damage, Strain Relief
-----------------------	--

Product Availability

Applicable Region	Americas, Asia, Global
-------------------	------------------------

Packaging Features

Packaging Method	Bulk Spool, Piece, Spool
------------------	--------------------------

Other

Meets Low Outgassing Requirements	No
Product Source	China, Czech Republic

SEE PRODUCTS ON NEXT PAGE



Products (1 of 5)



CGPE-105-1-X-SP



CGPE-105-3/64-9-SP



CGPE-105-3/64-0-SP



CGPE-105-3/64-X-SP

TE Part #	3354604002	2706814001	1211954001	1522834001
Primary Product Color	Clear	White	Black	Clear
Expanded Inside Diameter (Min)	25.4 mm	1.17 mm	1.17 mm	1.17 mm
Recovered Inside Diameter (Max)	12.7 mm	.58 mm	.58 mm	.58 mm
Packaging Method	Spool	Spool	Spool	Spool
Tubing Size Range				
Mechanical Resistance	Fluids, Mechanical Damage, Strain Relief	Fluids, Mechanical Damage, Strain Relief	Fluids, Mechanical Damage, Strain Relief	Fluids, Mechanical Damage, Strain Relief
Recovery Temperature	100 °C	100 °C	110 °C	100 °C
Meets Low Outgassing Requirements	No	No	No	No
Applicable Region	Global	Global	Global	Global
Product Source	China, Czech Republic	China, Czech Republic	China, Czech Republic	China, Czech Republic
EU RoHS Directive 2011/65 /EU	EU RoHS Compliant	EU RoHS Compliant	EU RoHS Compliant	EU RoHS Compliant
EU ELV Directive 2000/53/EC	EU ELV Compliant	EU ELV Compliant	EU ELV Compliant	EU ELV Compliant
Product Families	RAYCHEM	RAYCHEM	RAYCHEM	RAYCHEM
Series	RAYCHEM CGPE-105	RAYCHEM CGPE-105	RAYCHEM CGPE-105	RAYCHEM CGPE-105

*EU RoHS Directive 2011/65/EU

These products comply with the substance restrictions of the Restriction on Hazardous Substances Directive 2011/65/EU (RoHS2). The RoHS2 Directive requires that certain electrical and electronic equipment products do not contain mercury, cadmium, hexavalent chromium, PBB, PBDE, lead, DEHP, BBP, DBP and DIBP above defined thresholds. Products indicated as 'Compliant' do not contain any of these substances above the prohibition thresholds. Finished electrical and electronic equipment products will be CE marked as required by the Directive. Components may not be CE marked.

**EU ELV Directive 2000/53/EC

These products comply with the substance restrictions of the End of Life Vehicles Directive 2000/53/EC (ELV). The ELV Directive requires that materials and components of vehicles do not contain mercury, cadmium, hexavalent chromium, and lead above defined thresholds. Products indicated as 'Compliant' do not contain any of these substances above the prohibition thresholds.



Products (2 of 5)



	CGPE-105-1-2-SP	CGPE-105-1-6-SP	CGPE-105-3/16-X-BULK-SP	CGPE-105-3/16-9-SP
TE Part #	4531134001	3126294002	E77201-000	9852794002
Primary Product Color	Red	Blue	Clear	White
Expanded Inside Diameter (Min)	25.4 mm	25.4 mm	4.8 mm	4.8 mm
Recovered Inside Diameter (Max)	12.7 mm	12.7 mm	2.36 mm	2.36 mm
Packaging Method	Spool	Spool	Bulk Spool	Spool
Tubing Size Range			2.4 - 4.8 mm	2.4 - 4.8 mm
Mechanical Resistance	Fluids, Mechanical Damage, Strain Relief	Fluids, Mechanical Damage, Strain Relief	Fluids, Mechanical Damage, Strain Relief	Fluids, Mechanical Damage, Strain Relief
Recovery Temperature	100 °C	100 °C	100 °C	100 °C
Meets Low Outgassing Requirements	No	No	No	No
Applicable Region	Global	Global	Global	Global
Product Source	China, Czech Republic	China, Czech Republic	China, Czech Republic	China, Czech Republic
EU RoHS Directive 2011/65 /EU	EU RoHS Compliant	EU RoHS Compliant	EU RoHS Compliant	EU RoHS Compliant
EU ELV Directive 2000/53/EC	EU ELV Compliant	EU ELV Compliant	EU ELV Compliant	EU ELV Compliant
Product Families	RAYCHEM	RAYCHEM	RAYCHEM	RAYCHEM
Series	RAYCHEM CGPE-105	RAYCHEM CGPE-105	RAYCHEM CGPE-105	RAYCHEM CGPE-105

*EU RoHS Directive 2011/65/EU

These products comply with the substance restrictions of the Restriction on Hazardous Substances Directive 2011/65/EU (RoHS2). The RoHS2 Directive requires that certain electrical and electronic equipment products do not contain mercury, cadmium, hexavalent chromium, PBB, PBDE, lead, DEHP, BBP, DBP and DIBP above defined thresholds. Products indicated as 'Compliant' do not contain any of these substances above the prohibition thresholds. Finished electrical and electronic equipment products will be CE marked as required by the Directive. Components may not be CE marked.

**EU ELV Directive 2000/53/EC

These products comply with the substance restrictions of the End of Life Vehicles Directive 2000/53/EC (ELV). The ELV Directive requires that materials and components of vehicles do not contain mercury, cadmium, hexavalent chromium, and lead above defined thresholds. Products indicated as 'Compliant' do not contain any of these substances above the prohibition thresholds.



Products (3 of 5)

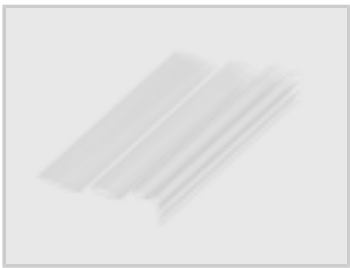

	CGPE-105-1/4-X-SP	CGPE-105-3/16-0-SP	CGPE-105-3/4-X-FSP	CGPE-105-1/8-2-SP
TE Part #	0582484002	5385094002	ER8226-000	0424744001
Primary Product Color	Clear	Black	Clear	Red
Expanded Inside Diameter (Min)	6.35 mm	4.74 mm, 4.75 mm	19.05 mm	3.17 mm
Recovered Inside Diameter (Max)	3.2 mm	2.36 mm	9.5 mm	1.57 mm
Packaging Method	Spool	Spool	Spool	Spool
Tubing Size Range	3.2 - 6.35 mm			
Mechanical Resistance	Fluids, Mechanical Damage, Strain Relief	Fluids, Mechanical Damage, Strain Relief	Fluids, Mechanical Damage, Strain Relief	Fluids, Mechanical Damage, Strain Relief
Recovery Temperature	100 °C	110 °C	110 °C	100 °C
Meets Low Outgassing Requirements	No	No	No	No
Applicable Region	Global	Global	Global	Global
Product Source	China, Czech Republic	China, Czech Republic	China, Czech Republic	China, Czech Republic
EU RoHS Directive 2011/65 /EU	EU RoHS Compliant	EU RoHS Compliant	EU RoHS Compliant	EU RoHS Compliant
EU ELV Directive 2000/53/EC	EU ELV Compliant	EU ELV Compliant	EU ELV Compliant	EU ELV Compliant
Product Families	RAYCHEM	RAYCHEM	RAYCHEM	RAYCHEM
Series	RAYCHEM CGPE-105	RAYCHEM CGPE-105	RAYCHEM CGPE-105	RAYCHEM CGPE

*EU RoHS Directive 2011/65/EU

These products comply with the substance restrictions of the Restriction on Hazardous Substances Directive 2011/65/EU (RoHS2). The RoHS2 Directive requires that certain electrical and electronic equipment products do not contain mercury, cadmium, hexavalent chromium, PBB, PBDE, lead, DEHP, BBP, DBP and DIBP above defined thresholds. Products indicated as 'Compliant' do not contain any of these substances above the prohibition thresholds. Finished electrical and electronic equipment products will be CE marked as required by the Directive. Components may not be CE marked.

**EU ELV Directive 2000/53/EC

These products comply with the substance restrictions of the End of Life Vehicles Directive 2000/53/EC (ELV). The ELV Directive requires that materials and components of vehicles do not contain mercury, cadmium, hexavalent chromium, and lead above defined thresholds. Products indicated as 'Compliant' do not contain any of these substances above the prohibition thresholds.



Products (4 of 5)

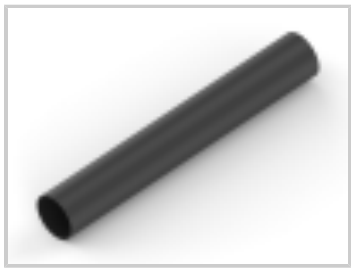

	CGPE-105-1/8-6-SP	CGPE-105-1/2-X-SP	CGPE-105-3/4-0-SP	CGPE-HW-12-A1-0-10.3MM
TE Part #	5834654001	5223654002	2945944002	2949076002
Primary Product Color	Blue	Clear	Black	Black
Expanded Inside Diameter (Min)	3.17 mm	12.7 mm	19.05 mm	11.96 mm
Recovered Inside Diameter (Max)	1.57 mm	6.35 mm	9.5 mm	7.49 mm
Packaging Method	Spool	Spool	Spool	Piece
Tubing Size Range				
Mechanical Resistance	Fluids, Mechanical Damage, Strain Relief	Fluids, Mechanical Damage, Strain Relief	Fluids, Mechanical Damage, Strain Relief	Fluids, Mechanical Damage, Strain Relief
Recovery Temperature	100 °C	100 °C	110 °C	110 °C
Meets Low Outgassing Requirements	No	No	No	No
Applicable Region	Global	Global	Global	Americas, Asia
Product Source	China, Czech Republic	China, Czech Republic	China, Czech Republic	China, Czech Republic
EU RoHS Directive 2011/65 /EU	EU RoHS Compliant	EU RoHS Compliant	EU RoHS Compliant	EU RoHS Compliant
EU ELV Directive 2000/53/EC	EU ELV Compliant	EU ELV Compliant	EU ELV Compliant	EU ELV Compliant
Product Families	RAYCHEM	RAYCHEM	RAYCHEM	RAYCHEM
Series	RAYCHEM CGPE-105	RAYCHEM CGPE-105	RAYCHEM CGPE-105	RAYCHEM CGPE-HW

*EU RoHS Directive 2011/65/EU

These products comply with the substance restrictions of the Restriction on Hazardous Substances Directive 2011/65/EU (RoHS2). The RoHS2 Directive requires that certain electrical and electronic equipment products do not contain mercury, cadmium, hexavalent chromium, PBB, PBDE, lead, DEHP, BBP, DBP and DIBP above defined thresholds. Products indicated as 'Compliant' do not contain any of these substances above the prohibition thresholds. Finished electrical and electronic equipment products will be CE marked as required by the Directive. Components may not be CE marked.

**EU ELV Directive 2000/53/EC

These products comply with the substance restrictions of the End of Life Vehicles Directive 2000/53/EC (ELV). The ELV Directive requires that materials and components of vehicles do not contain mercury, cadmium, hexavalent chromium, and lead above defined thresholds. Products indicated as 'Compliant' do not contain any of these substances above the prohibition thresholds.



Products (5 of 5)



CGPE-105-1/2-0-SP



CGPE-105-1/16-0-SP



CGPE-105-1/8-4-SP



CGPE-105-3/8-0-SP

TE Part #	3954384002	4944904001	4685294002	4862984002
Primary Product Color	Black	Black	Yellow	Black
Expanded Inside Diameter (Min)	12.7 mm	1.6 mm	3.2 mm	9.5 mm
Recovered Inside Diameter (Max)	6.35 mm	.8 mm	1.6 mm	4.8 mm
Packaging Method	Spool	Spool	Spool	Spool
Tubing Size Range		.8 - 1.6 mm	1.6 - 3.2 mm	4.8 - 9.5 mm
Mechanical Resistance	Fluids, Mechanical Damage, Strain Relief	Fluids, Mechanical Damage, Strain Relief	Fluids, Mechanical Damage, Strain Relief	Fluids, Mechanical Damage, Strain Relief
Recovery Temperature	110 °C	110 °C	100 °C	110 °C
Meets Low Outgassing Requirements	No	No	No	No
Applicable Region	Global	Global	Global	Global
Product Source	China, Czech Republic	China, Czech Republic	China, Czech Republic	China, Czech Republic
EU RoHS Directive 2011/65 /EU	EU RoHS Compliant	EU RoHS Compliant	EU RoHS Compliant	EU RoHS Compliant
EU ELV Directive 2000/53/EC	EU ELV Compliant	EU ELV Compliant	EU ELV Compliant	EU ELV Compliant
Product Families	RAYCHEM	RAYCHEM	RAYCHEM	RAYCHEM
Series	RAYCHEM CGPE-105	RAYCHEM CGPE-105	RAYCHEM CGPE-105	RAYCHEM CGPE-105

*EU RoHS Directive 2011/65/EU

These products comply with the substance restrictions of the Restriction on Hazardous Substances Directive 2011/65/EU (RoHS2). The RoHS2 Directive requires that certain electrical and electronic equipment products do not contain mercury, cadmium, hexavalent chromium, PBB, PBDE, lead, DEHP, BBP, DBP and DIBP above defined thresholds. Products indicated as 'Compliant' do not contain any of these substances above the prohibition thresholds. Finished electrical and electronic equipment products will be CE marked as required by the Directive. Components may not be CE marked.

**EU ELV Directive 2000/53/EC

These products comply with the substance restrictions of the End of Life Vehicles Directive 2000/53/EC (ELV). The ELV Directive requires that materials and components of vehicles do not contain mercury, cadmium, hexavalent chromium, and lead above defined thresholds. Products indicated as 'Compliant' do not contain any of these substances above the prohibition thresholds.



Related Materials

Catalog Section

CGPE-105 Pages from 9-1773447-9

English

Also in the Series | RAYCHEM CGPE

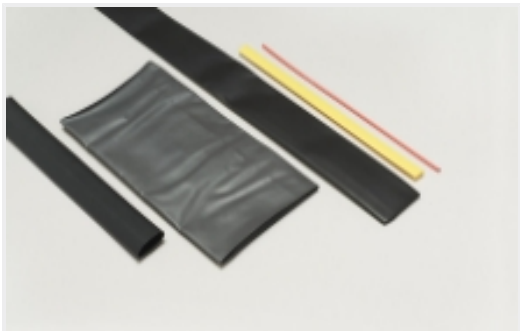

Heat Shrink Tubing(2)

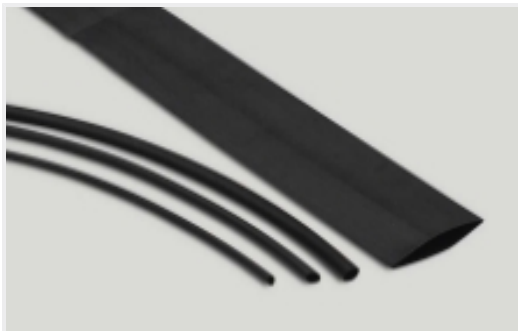

Single Wall Tubing(2)