

ATUM 3:1 Heat Shrink Tubing

RAYCHEM | RAYCHEM ATUM
[View on TE.com >](#)



Heat Shrink Tubing

ATUM is a flame-retardant heat shrink tubing that is semi-flexible, electrically insulating, and comes in 3:1 expansion ratio formats. Custom formulation for dual wall tubings by varying jacket and adhesive combinations



Primary Product Color: **Black**
Wall Type: **Dual Wall**
Expanded Inside Diameter (Min): **12 mm**
Recovered Inside Diameter (Max): **4 mm**
Shrink Ratio: **3:1**

Features

Reference Number

TE Internal Number	CAT-HST-ATUM2
--------------------	---------------

Product Type Features

Tubing Product Type	Heat Shrink Tubing
Wall Type	Dual Wall

Electrical Characteristics

Operating Voltage (Max) (kV)	.6
------------------------------	----

Body Features

Fluid Type	Aviation Fuel, Chemicals/Solvents, De-Icing Fluid, Diesel Fluid, Diesel Fuel, Hydraulic Fluid, Lubricating Oil, Water
Primary Product Color	Black, Blue, Brown, Clear, Green, Red, White, Yellow
Shrink Ratio	3:1
Primary Product Material	Irradiated Modified Polyolefin
Flexibility	Semi-Flexible

Dimensions

Recovered Wall Thickness (Tolerance) (mm)	.1, .28, .3, .38, .55
Recovered Wall Thickness (Tolerance) (in)	.011, .012, .015, .022
Product Length (mm)	17, 20, 25, 30, 35, 38, 40, 45, 47, 50, 50.8, 54,



	55, 60, 65, 69.85, 70, 75, 76.2, 80, 85, 100, 110, 114, 120, 140, 150, 165, 175, 180, 200, 250, 600, 650, 950, 1000, 1220
Product Length (in)	.669, .787, .984, 1.181, 1.378, 1.496, 1.575, 1.771, 1.772, 1.85, 1.969, 2, 2.125, 2.165, 2.362, 2.559, 2.75, 2.756, 2.953, 3, 3.15, 3.346, 3.937, 4.331, 4.5, 4.724, 5.512, 5.906, 6.496, 6.89, 7.087, 7.874, 9.843, 23.622, 25.591, 37.402, 39.37, 48.031
Recovered Wall Thickness (Nominal) (mm)	1, 1.4, 1.78, 2.25, 2.54
Recovered Wall Thickness (Nominal) (in)	.01, .039, .055, .07, .088, .089, .1
Recovered Inside Diameter (Max) (mm)	1, 1.5, 2, 3, 4, 6, 8, 13
Recovered Inside Diameter (Max) (in)	.039, .059, .079, .118, .157, .236, .315, .512
Expanded Inside Diameter (Min) (mm)	3, 3.94, 4.5, 6, 9, 12, 19, 24, 40
Expanded Inside Diameter (Min) (in)	.115, .118, .177, .236, .354, .472, .748, .945, 1.575
Tubing Size Range (mm)	.9 - 3.7, 1 - 3, 1.5 - 4.5, 2 - 6, 3 - 9, 4 - 12, 6 - 19, 8 - 24, 13 - 40
Tubing Size Range (in)	.035 - 1.45, .039 - .118, .059 - .177, .079 - .236, .118 - .354, .157 - .472, .158 - .472, .236 - .748, .236 - .63, .315 - .94, .51 - 1.57, .512 - 1.575

Usage Conditions

Shrink Temperature (Min) (°C)	80
Tubing Flammability Type	Flame-Retardant, Non-Flame-Retardant
Operating Temperature Range (°C)	-55 - 110
Recovery Temperature (°C)	110

Operation/Application

Mechanical Resistance	Fluids, Mechanical Damage, Strain Relief
-----------------------	--

Product Availability

Applicable Region	Global
-------------------	--------

Packaging Features

Packaging Method	Bag & Box, Box, Piece, Reel, Reel/Box, Spool
------------------	--

Other

Meets Low Outgassing Requirements	No
Product Source	Czech Republic



SEE PRODUCTS ON NEXT PAGE



Products (1 of 5)

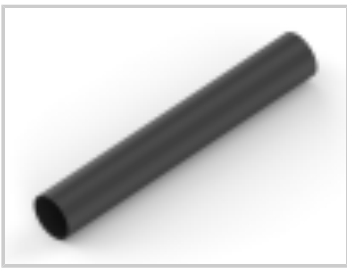

ATUM-12/4-0-180MM

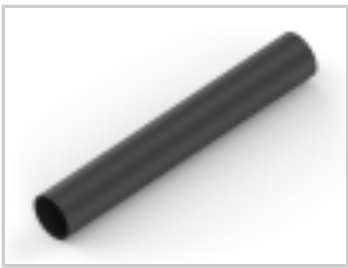

ATUM-12/4-0-1M



ATUM-12/4-0-25MM



ATUM-12/4-0-70MM

TE Part #	NB09096001	NB09108001	NB09136001	NB09226001
Primary Product Color	Black	Black	Black	Black
Expanded Inside Diameter (Min)	12 mm	12 mm	12 mm	12 mm
Recovered Inside Diameter (Max)	4 mm	4 mm	4 mm	4 mm
Tubing Product Type	Heat Shrink Tubing	Heat Shrink Tubing	Heat Shrink Tubing	Heat Shrink Tubing
Tubing Flammability Type	Flame-Retardant	Flame-Retardant	Flame-Retardant	Flame-Retardant
Packaging Method	Box	Bag & Box	Box	Box
Tubing Size Range	4 - 12 mm	4 - 12 mm	4 - 12 mm	4 - 12 mm
Mechanical Resistance	Mechanical Damage	Mechanical Damage	Mechanical Damage	Mechanical Damage
EU RoHS Directive 2011/65 /EU	EU RoHS Compliant	EU RoHS Compliant	EU RoHS Compliant	EU RoHS Compliant
EU ELV Directive 2000/53 /EC	EU ELV Compliant	EU ELV Compliant	EU ELV Compliant	EU ELV Compliant
Product Families	RAYCHEM	RAYCHEM	RAYCHEM	RAYCHEM
Series	RAYCHEM ATUM	RAYCHEM ATUM	RAYCHEM ATUM	RAYCHEM ATUM

*EU RoHS Directive 2011/65/EU

These products comply with the substance restrictions of the Restriction on Hazardous Substances Directive 2011/65/EU (RoHS2). The RoHS2 Directive requires that certain electrical and electronic equipment products do not contain mercury, cadmium, hexavalent chromium, PBB, PBDE, lead, DEHP, BBP, DBP and DIBP above defined thresholds. Products indicated as 'Compliant' do not contain any of these substances above the prohibition thresholds. Finished electrical and electronic equipment products will be CE marked as required by the Directive. Components may not be CE marked.

**EU ELV Directive 2000/53/EC

These products comply with the substance restrictions of the End of Life Vehicles Directive 2000/53/EC (ELV). The ELV Directive requires that materials and components of vehicles do not contain mercury, cadmium, hexavalent chromium, and lead above defined thresholds. Products indicated as 'Compliant' do not contain any of these substances above the prohibition thresholds.



Products (2 of 5)

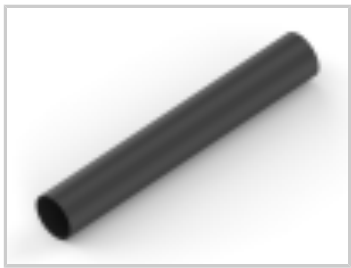

ATUM-12/4-0-75MM

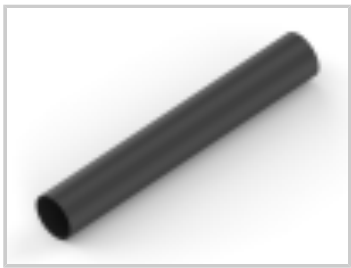

ATUM-19/6-0-140MM



ATUM-19/6-0-60MM

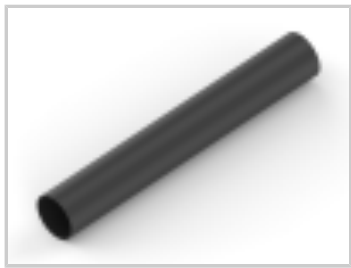

ATUM-3/1-0-45MM

TE Part #	NB09236001	NB09696001	NB09866001	NB10496001
Primary Product Color	Black	Black	Black	Black
Expanded Inside Diameter (Min)	12 mm	19 mm	19 mm	3 mm
Recovered Inside Diameter (Max)	4 mm	6 mm	6 mm	1 mm
Tubing Product Type	Heat Shrink Tubing	Heat Shrink Tubing	Heat Shrink Tubing	Heat Shrink Tubing
Tubing Flammability Type	Flame-Retardant	Flame-Retardant	Flame-Retardant	Flame-Retardant
Packaging Method	Box	Box	Box	Box
Tubing Size Range	4 - 12 mm	6 - 19 mm	6 - 19 mm	1 - 3 mm
Mechanical Resistance	Mechanical Damage	Mechanical Damage	Mechanical Damage	Fluids, Mechanical Damage, Strain Relief
EU RoHS Directive 2011/65 /EU	EU RoHS Compliant	EU RoHS Compliant	EU RoHS Compliant	EU RoHS Compliant
EU ELV Directive 2000/53/EC	EU ELV Compliant	EU ELV Compliant	EU ELV Compliant	EU ELV Compliant
Product Families	RAYCHEM	RAYCHEM	RAYCHEM	RAYCHEM
Series	RAYCHEM ATUM	RAYCHEM ATUM	RAYCHEM ATUM	RAYCHEM ATUM

*EU RoHS Directive 2011/65/EU

These products comply with the substance restrictions of the Restriction on Hazardous Substances Directive 2011/65/EU (RoHS2). The RoHS2 Directive requires that certain electrical and electronic equipment products do not contain mercury, cadmium, hexavalent chromium, PBB, PBDE, lead, DEHP, BBP, DBP and DIBP above defined thresholds. Products indicated as 'Compliant' do not contain any of these substances above the prohibition thresholds. Finished electrical and electronic equipment products will be CE marked as required by the Directive. Components may not be CE marked.

**EU ELV Directive 2000/53/EC

These products comply with the substance restrictions of the End of Life Vehicles Directive 2000/53/EC (ELV). The ELV Directive requires that materials and components of vehicles do not contain mercury, cadmium, hexavalent chromium, and lead above defined thresholds. Products indicated as 'Compliant' do not contain any of these substances above the prohibition thresholds.



Products (3 of 5)

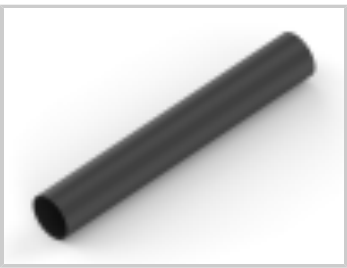

	ATUM-9/3-0-80MM	ATUM-12/4-0-45MM	ATUM-12/4-0-165MM	ATUM-19/6-0-150MM
TE Part #	NB11996001	EM52966001	NB09076001	NB09706001
Primary Product Color	Black	Black	Black	Black
Expanded Inside Diameter (Min)	9 mm	12 mm	12 mm	19 mm
Recovered Inside Diameter (Max)	3 mm	4 mm	4 mm	6 mm
Tubing Product Type	Heat Shrink Tubing	Heat Shrink Tubing	Heat Shrink Tubing	Heat Shrink Tubing
Tubing Flammability Type	Flame-Retardant	Flame-Retardant	Flame-Retardant	Flame-Retardant
Packaging Method	Box	Box	Box	Box
Tubing Size Range	3 - 9 mm	4 - 12 mm	4 - 12 mm	6 - 19 mm
Mechanical Resistance	Fluids, Mechanical Damage	Fluids, Mechanical Damage, Strain Relief	Mechanical Damage	Mechanical Damage
EU RoHS Directive 2011/65 /EU	EU RoHS Compliant	EU RoHS Compliant	EU RoHS Compliant	EU RoHS Compliant
EU ELV Directive 2000/53/EC	EU ELV Compliant	EU ELV Compliant	EU ELV Compliant	EU ELV Compliant
Product Families	RAYCHEM	RAYCHEM	RAYCHEM	RAYCHEM
Series	RAYCHEM ATUM	RAYCHEM ATUM	RAYCHEM ATUM	RAYCHEM ATUM

*EU RoHS Directive 2011/65/EU

These products comply with the substance restrictions of the Restriction on Hazardous Substances Directive 2011/65/EU (RoHS2). The RoHS2 Directive requires that certain electrical and electronic equipment products do not contain mercury, cadmium, hexavalent chromium, PBB, PBDE, lead, DEHP, BBP, DBP and DIBP above defined thresholds. Products indicated as 'Compliant' do not contain any of these substances above the prohibition thresholds. Finished electrical and electronic equipment products will be CE marked as required by the Directive. Components may not be CE marked.

**EU ELV Directive 2000/53/EC

These products comply with the substance restrictions of the End of Life Vehicles Directive 2000/53/EC (ELV). The ELV Directive requires that materials and components of vehicles do not contain mercury, cadmium, hexavalent chromium, and lead above defined thresholds. Products indicated as 'Compliant' do not contain any of these substances above the prohibition thresholds.



Products (4 of 5)

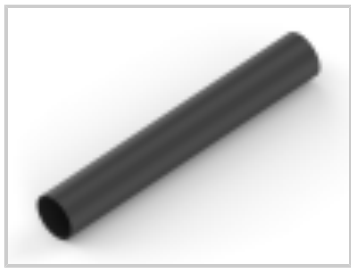

ATUM-19/6-0-30MM

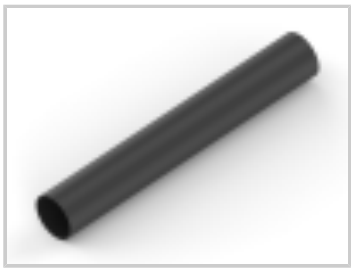

ATUM-40/13-0-85MM



ATUM-6/2-0-1M



ATUM-6/2-0-45MM

TE Part #	NB09796001	NB11166001	NB11488001	NB11586001
Primary Product Color	Black	Black	Black	Black
Expanded Inside Diameter (Min)	19 mm	40 mm	6 mm	6 mm
Recovered Inside Diameter (Max)	6 mm	13 mm	2 mm	2 mm
Tubing Product Type	Heat Shrink Tubing	Heat Shrink Tubing	Heat Shrink Tubing	Heat Shrink Tubing
Tubing Flammability Type	Flame-Retardant	Flame-Retardant	Flame-Retardant	Flame-Retardant
Packaging Method	Box	Box	Bag & Box	Box
Tubing Size Range	6 - 19 mm	13 - 40 mm	2 - 6 mm	2 - 6 mm
Mechanical Resistance	Mechanical Damage	Fluids, Mechanical Damage	Fluids, Mechanical Damage	Fluids, Mechanical Damage
EU RoHS Directive 2011/65 /EU	EU RoHS Compliant	EU RoHS Compliant	EU RoHS Compliant	EU RoHS Compliant
EU ELV Directive 2000/53 /EC	EU ELV Compliant	EU ELV Compliant	EU ELV Compliant	EU ELV Compliant
Product Families	RAYCHEM	RAYCHEM	RAYCHEM	RAYCHEM
Series	RAYCHEM ATUM	RAYCHEM ATUM	RAYCHEM ATUM	RAYCHEM ATUM

*EU RoHS Directive 2011/65/EU

These products comply with the substance restrictions of the Restriction on Hazardous Substances Directive 2011/65/EU (RoHS2). The RoHS2 Directive requires that certain electrical and electronic equipment products do not contain mercury, cadmium, hexavalent chromium, PBB, PBDE, lead, DEHP, BBP, DBP and DIBP above defined thresholds. Products indicated as 'Compliant' do not contain any of these substances above the prohibition thresholds. Finished electrical and electronic equipment products will be CE marked as required by the Directive. Components may not be CE marked.

**EU ELV Directive 2000/53/EC

These products comply with the substance restrictions of the End of Life Vehicles Directive 2000/53/EC (ELV). The ELV Directive requires that materials and components of vehicles do not contain mercury, cadmium, hexavalent chromium, and lead above defined thresholds. Products indicated as 'Compliant' do not contain any of these substances above the prohibition thresholds.



Products (5 of 5)

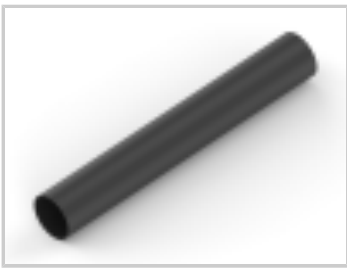

ATUM-9/3-0-75MM



ATUM-12/4-0-20MM

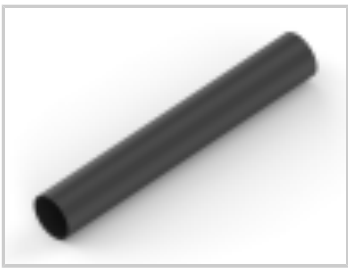

ATUM-12/4-0-600MM

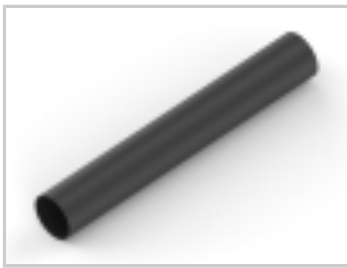

ATUM-12/4-0-100MM

TE Part #	NB11986001	NB09126001	NB09216001	NB09056001
Primary Product Color	Black	Black	Black	Black
Expanded Inside Diameter (Min)	9 mm	12 mm	12 mm	12 mm
Recovered Inside Diameter (Max)	3 mm	4 mm	4 mm	4 mm
Tubing Product Type	Heat Shrink Tubing	Heat Shrink Tubing	Heat Shrink Tubing	Heat Shrink Tubing
Tubing Flammability Type	Flame-Retardant	Flame-Retardant	Flame-Retardant	Flame-Retardant
Packaging Method	Box	Box	Box	Box
Tubing Size Range	3 - 9 mm	4 - 12 mm	4 - 12 mm	4 - 12 mm
Mechanical Resistance	Fluids, Mechanical Damage	Mechanical Damage	Mechanical Damage	Mechanical Damage
EU RoHS Directive 2011/65 /EU	EU RoHS Compliant	EU RoHS Compliant	EU RoHS Compliant	EU RoHS Compliant
EU ELV Directive 2000/53 /EC	EU ELV Compliant	EU ELV Compliant	EU ELV Compliant	EU ELV Compliant
Product Families	RAYCHEM	RAYCHEM	RAYCHEM	RAYCHEM
Series	RAYCHEM ATUM	RAYCHEM ATUM	RAYCHEM ATUM	RAYCHEM ATUM

*EU RoHS Directive 2011/65/EU

These products comply with the substance restrictions of the Restriction on Hazardous Substances Directive 2011/65/EU (RoHS2). The RoHS2 Directive requires that certain electrical and electronic equipment products do not contain mercury, cadmium, hexavalent chromium, PBB, PBDE, lead, DEHP, BBP, DBP and DIBP above defined thresholds. Products indicated as 'Compliant' do not contain any of these substances above the prohibition thresholds. Finished electrical and electronic equipment products will be CE marked as required by the Directive. Components may not be CE marked.

**EU ELV Directive 2000/53/EC

These products comply with the substance restrictions of the End of Life Vehicles Directive 2000/53/EC (ELV). The ELV Directive requires that materials and components of vehicles do not contain mercury, cadmium, hexavalent chromium, and lead above defined thresholds. Products indicated as 'Compliant' do not contain any of these substances above the prohibition thresholds.



Related Materials

[Data Sheet](#)
[ATUM Tubing](#)
English

Also in the Series | [RAYCHEM ATUM](#)



Dual Wall Tubing(220)

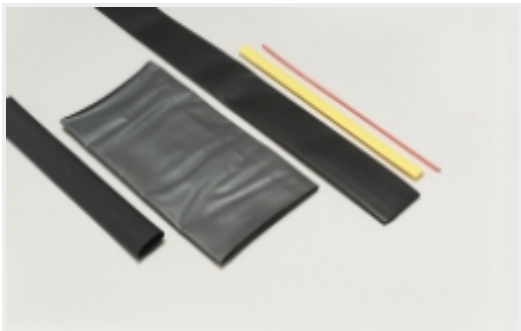

Heat Shrink Tubing(220)

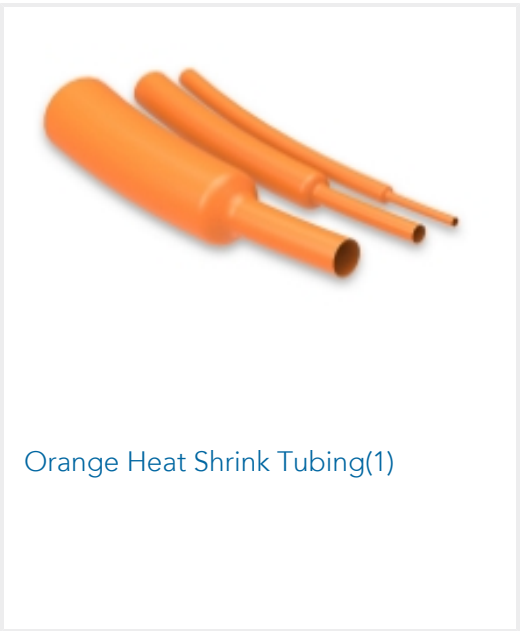

Orange Heat Shrink Tubing(1)